

# Michigan Interscholastic Horsemanship Association



## Region B Information Packet Divisions A/C October 3-4 2020

Fowlerville Family Fairgrounds  
8800 W. Grand River Ave  
Fowlerville MI 48836  
Telephone: 517.223.8186  
[www.fowlervillefamilyfair.com](http://www.fowlervillefamilyfair.com)

# Regional Information

## SCHEDULE

Friday – October 2, 2020		Saturday – October 3, 2020		Sunday – October 4, 2020	
Haul in/Set up	4:00 PM	Judges/Coaches Meeting	7:30AM	Judges/Coaches Meeting	7:30 AM
Registration	4:00-6:00PM	Regional Championships	8:00AM	Regional Championships	8:00 AM 30 Min after last class

## CLASS LIST SATURDAY

		Ring 1 (Main Arena) Saturday	Ring 2 Saturday
		8:00am Start	8:00am Start
1		Western Showmanship (A,C)	
2		Hunt Seat Showmanship (A,C)	
3		Saddle Seat Showmanship (A,C)	
4	Starting 10 Min After Showmanship		SS Pattern (A/C)
5	Starting Immediately after A Division SS Pattern	Saddle Seat Equitation (A,C)	
6		Saddle Seat Bareback (A,C)	
7		Equitation Over Fences (A,C)	
8		Hunt Seat Equitation (A,C)	
9		Hunt Seat Bareback (A,C)	
10		Flag Relay	
11		Cloverleaf	

## SUNDAY

		Ring 1 (Indoor) Sunday	Ring 2 Sunday
		8:00 Start	8:00am Start
1		Reining (A,C)	Trail (C,A) Walkthrough will be from 7:15-8:00
2		Western Equitation (C,A)	
4		Western Bareback (C,A)	
5		Stake Race	
6		2-Man Relay	

*The schedule is subject to change.*

# General Information

- The Show Office is located beside the main arena
- Stalls will be assigned. Please e-mail **Lauren Fetner** with the number of horse and tack stalls required for your team by Monday, September 28. Her e-mail address is [Lrkrame2@gmail.com](mailto:Lrkrame2@gmail.com).
- Please check-in with the Show Office when you arrive to register your team.
- Slot sheets must be emailed to the show secretary no later than Wednesday, September 30 at 12:00 PM. Her e-mail address is [district11dc@outlook.com](mailto:district11dc@outlook.com)
- **Shavings will not be available for purchase at the facility, please bring your own.**
- Stalls **MUST BE STRIPPED** prior to leaving the grounds
- Checks must be made payable to **MIHA Region B**.
- Team duties will be assigned and distributed via email before September 30, 2020.
- Additional duties will be assigned as needed.
- The top 2 of the 4 teams competing in each division will go to State Championships.
- All equitation classes will require a pattern and top riders will be called back for rail work.
- All patterns (except those provided in our rulebook) were randomly selected by the MIHA Patterns Committee.
- You are responsible for downloading and printing your own copies of the patterns. Patterns will be posted **September 28<sup>th</sup>, 2020** on [www.miha.org](http://www.miha.org) under the Patterns section. **Patterns will not be provided in the registration packet or in the show office.**
- It is your responsibility to notify the Regional Chairperson if your team is not attending the Regional Championship.

## Contact Information

<b>Show Chair</b> Lauren Fetner (810) 923-6346 <a href="mailto:Lrkrame2@gmail.com">Lrkrame2@gmail.com</a>	<b>District I</b> Lisa Pollock (248) 882-0612 <a href="mailto:lisacllydep@gmail.com">lisacllydep@gmail.com</a>	<b>District 11</b> Susan Bannister (810) 397-8837 <a href="mailto:district11dc@outlook.com">district11dc@outlook.com</a>	<b>District 12</b> Bob Clogg (586) 615-1828 <a href="mailto:cowboybob@comcast.net">cowboybob@comcast.net</a>	<b>District 7</b> Myra Zolynsky (248) 231-9165 <a href="mailto:Mzolynsky1@aol.com">Mzolynsky1@aol.com</a>
--	---	---	---	--

# Fairgrounds Map

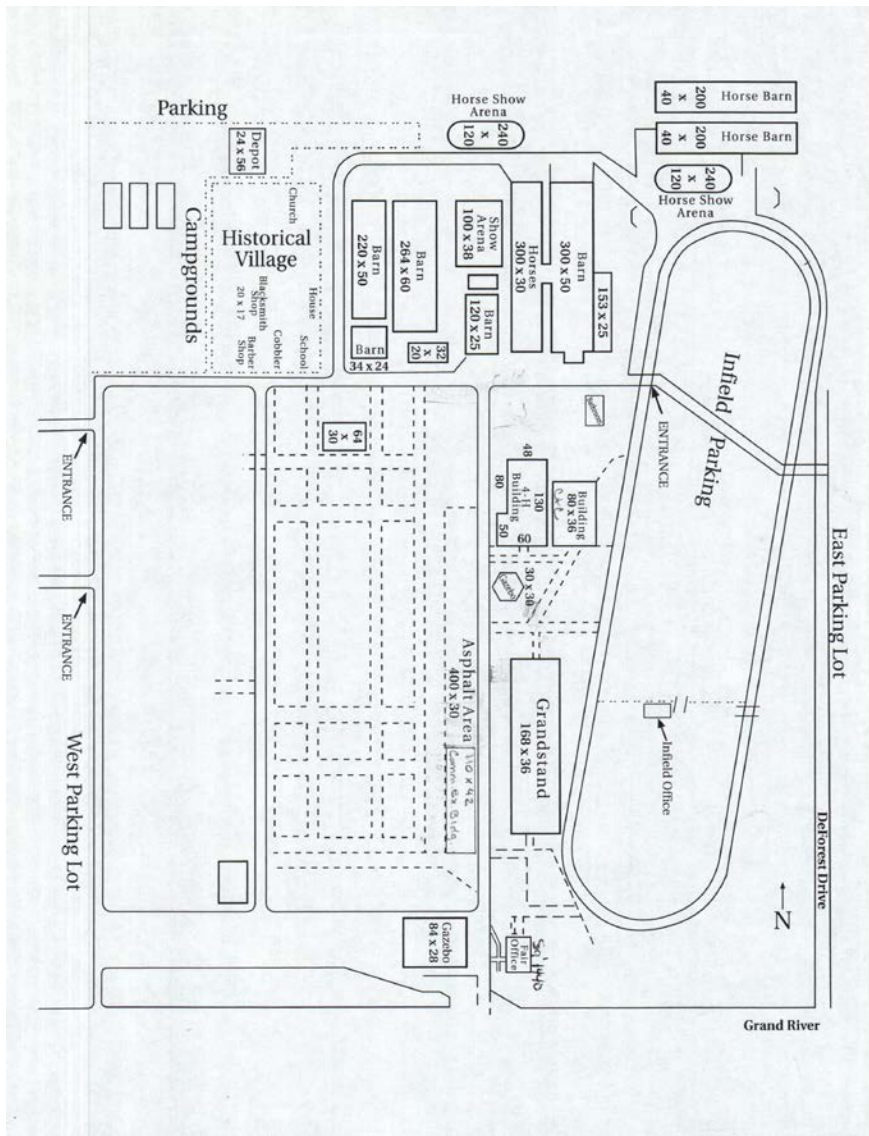

## HOTEL & MOTEL INFORMATION

**Baymont By Wyndham**  
 4120 Lambert Dr  
 Howell, MI, US, 48855  
 Telephone: 517.546.0712

**Holiday Inn Express**  
 1397 N. Burkhart Rd  
 Howell, MI 48855  
 Telephone: 517.548.0100

Additional Hotels in Howell and Okemos

## Camping Rules

1. Upon arrival, campers must check in with the Office for their sites location and camping permits. The Permits must be displayed in the camping unit. ALL PERMITS MUST FACE ROADSIDE.
2. NO SWITCHING OF SITES will be granted without authorization from office. Those who are found changing sites will be asked to leave and will not receive refund.
3. Each campsite will be required to have a responsible adult (age 18 or above) staying in the camper at night and their name listed on the application form for supervising younger members of the camping group. The names of all the members of the camping group shall be listed on the application and the name and phone number of the person or persons to contact in case of an emergency. This will be strictly enforced.
4. Campers are to be quiet after 11:00pm – This will be strictly enforced.
5. No illegal drugs will be allowed on the grounds.
6. No dumping of wastewater on the grounds except in the dumping station.
7. All water hoses and trailer connections MUST not leak. If this becomes a problem they will be disconnected by the campgrounds supervisor.
8. Electrical cords MUST be a 12 gauge or better with the proper ground.
9. Fire lanes are to be kept clear at all times.
10. If you have animals (pets) you are responsible for clean-up. The animal MUST be kept quiet (if possible) and at your site unless on a leash with you. During events, animals (pets) are NOT allowed in public areas. MUST be kept at campsite.
11. Campfires must be kept contained. Please see office.
12. A maximum of six people will be allowed to stay in any one campsite.
13. Any camper or member of a camping group who violates any of these rules will have their camper permit revoked. They will be required to leave the fairgrounds and remove their camper from the grounds or they will be removed. Camping fees will be forfeited and no refunds will be made.
14. All hitches must be readily accessible (for emergency hookup).

***ALL FIRE PROTECTION RULES WILL BE ENFORCED.***

# 2020 MIHA REGION B REGISTRATION

TEAM NAME: \_\_\_\_\_

TEAM DIVISION: \_\_\_\_\_ (Circle One) **A- C** DISTRICT: \_\_\_\_\_ (Circle One) **1 - 7- 11- 12**

COACH: \_\_\_\_\_

ADDRESS: \_\_\_\_\_

MOBILE: \_\_\_\_\_ E-MAIL: \_\_\_\_\_

**Registration Worksheet**

<b>RIDERS</b>		<b>\$35</b>	<b>\$</b>
<b>STALLS</b>		<b>\$40</b>	<b>\$</b>
<b>CAMPING – FRIDAY</b>		<b>\$30</b>	<b>\$</b>
<b>CAMPING – SATURDAY</b>		<b>\$30</b>	<b>\$</b>
<b>T-SHIRTS*</b>		<b>\$10</b>	<b>\$</b>
			<b>\$</b>

- \*Shirts are first come first serve. There is no guarantee that your sizes will be available.

**Sample**

<b>RIDERS</b>	<b>10</b>	<b>\$35</b>	<b>\$350</b>
<b>STALLS</b>	<b>10</b>	<b>\$40</b>	<b>\$400</b>
<b>CAMPING – FRIDAY</b>	<b>10</b>	<b>\$30</b>	<b>\$300</b>
<b>CAMPING – SATURDAY</b>	<b>10</b>	<b>\$30</b>	<b>\$300</b>
<b>T-SHIRTS</b>	<b>5</b>	<b>\$10</b>	<b>\$50</b>
			<b>\$1400</b>

Please make checks payable to MIHA Region B.

COACH'S SIGNATURE: \_\_\_\_\_ DATE: \_\_\_\_\_

<i>Office Use Only</i>	
Payment:	Cash _____ Check _____
Check No:	_____
Initials:	_____

